

Metallbalgkupplung EWP

Metal bellows coupling EWP

- beidseitig mit Flanschnaben für variablen Anbau
- drei Standard Baulängen, radiale Montage
- kundenspezifische Anbauflansche

- flange hubs on both sides for variable mounting
- three standard lengths, radial mounting
- customized mounting flange

Technische Daten / technical data:

| EWP | | 50 | 65 | 100 | 200 | 300 | 450 | 540 | 900 | 1500 | 2500 |
|---|--------------------------------------|--------|--------|--------|--------|--------|--------|--------|--------|--------|-------|
| Nennmoment nominal torque | [Nm] | 50 | 65 | 100 | 200 | 300 | 450 | 540 | 900 | 1500 | 2500 |
| Trägheitsmoment moment of inertia | [10 ⁻³ kgm ²] | 0,09 | 0,22 | 0,54 | 0,6 | 1,7 | 1,9 | 3,7 | 8,5 | 13,8 | 49 |
| Torsionssteife torsional stiffness | 4W | 9 | 14 | 23 | 28 | 52 | 74 | 106 | 156 | - | - |
| | 6W | 6 | 9 | 14 | 18 | 33 | 47 | 67 | 99 | 240 | 400 |
| | 2x1W | 9 | 11 | 22 | 34 | 45 | 66 | 96 | - | 295 | 605 |
| max. Drehzahl max. speed | 4W/2x1W | 25.000 | 23.000 | 18.500 | 18.500 | 15.000 | 15.000 | 12.500 | 11.500 | 10.000 | 7.500 |
| | 6W | 20.000 | 20.000 | 16.000 | 16.000 | 13.000 | 13.000 | 11.000 | 10.000 | 8.500 | 6.500 |
| Wellenversatz max. lateral shaft displacement | 4W | 0,2 | 0,2 | 0,2 | 0,2 | 0,2 | 0,2 | 0,2 | 0,2 | - | - |
| | 6W | 0,25 | 0,3 | 0,3 | 0,3 | 0,3 | 0,3 | 0,3 | 0,3 | 0,3 | 0,3 |
| | 2x1W | 0,2 | 0,2 | 0,4 | 0,2 | 0,3 | 0,2 | 0,3 | - | 0,3 | 0,4 |
| Federsteife lateral spring rate | 4W | 480 | 650 | 280 | 1000 | 1350 | 1500 | 3000 | 3050 | - | - |
| | 6W | 190 | 260 | 280 | 470 | 450 | 640 | 980 | 1000 | 1500 | 1300 |
| | 2x1W | 160 | 85 | 110 | 299 | 156 | 247 | 370 | - | 480 | 550 |
| Federsteife axial spring rate | 4W | 70 | 70 | 64 | 98 | 94 | 135 | 145 | 210 | - | - |
| | 6W | 51 | 49 | 45 | 80 | 70 | 100 | 100 | 145 | 240 | 170 |
| | 2x1W | 165 | 90 | 125 | 350 | 212 | 305 | 300 | - | 520 | 550 |
| Masse ca. mass approx. | [kg] | 0,2 | 0,35 | 0,55 | 0,6 | 1,1 | 1,2 | 1,7 | 3,0 | 3,8 | 7,1 |
| Anziehmoment Schrauben tightening torque screws | [Nm] | 4 | 14 | 14 | 14 | 35 | 40 | 65 | 140 | 220 | 220 |



Beispielbild
Example

Werkstoff:
Balg: Edelstahl
Naben: Vergütungsstahl

material:
bellows: stainless steel
hubs: tempered steel

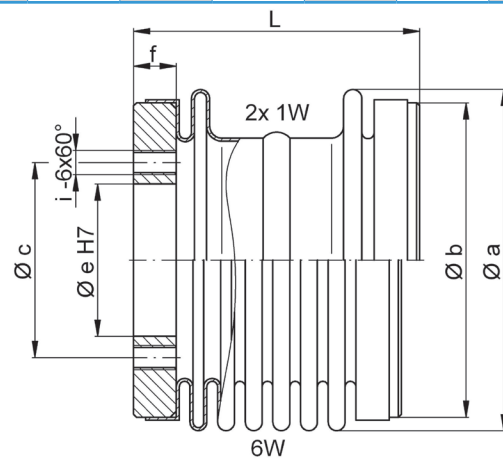

Abmessungen nach / dimensions acc. to DIN ISO 2768 cH:

| EWP | | 50 | 65 | 100 | 200 | 300 | 450 | 540 | 900 | 1500 | 2500 |
|-------|------|----|----|-----|-----|-----|-----|-----|-----|------|------|
| Øa | [mm] | 56 | 66 | 82 | 82 | 101 | 101 | 122 | 132 | 157 | 203 |
| Øb | [mm] | 52 | 62 | 78 | 78 | 96 | 96 | 111 | 127 | 140 | 194 |
| Øc | [mm] | 32 | 38 | 53 | 53 | 65 | 65 | 80 | 88 | 110 | 150 |
| Øe H7 | [mm] | 25 | 28 | 40 | 40 | 50 | 50 | 63 | 68 | 88 | 125 |
| f | [mm] | 7 | 9 | 9 | 9 | 12 | 12 | 15 | 20 | 24 | 24 |
| L | 4W | 35 | 41 | 44 | 46 | 53 | 57 | 66 | 77 | - | - |
| | 6W | 44 | 51 | 56 | 58 | 66 | 72 | 82 | 93 | 103 | 108 |
| | 2x1W | 47 | 59 | 68 | 74 | 89 | 89 | 102 | - | 144 | 172 |
| 6 x i | | M4 | M6 | M6 | M6 | M8 | M8 | M10 | M14 | M16 | M16 |

Temperaturbereich: -40 °C - +300 °C

3 Standard Baulängen:

4W - 4-welliger Balg; 6W - 6-welliger Balg;

2x1W - gerader Balg

weitere Balgvarianten auf Anfrage

temperature range: 233 K up to 573 K

3 standard types:

4W - 4-corrugation bellows; 6W - 6-corrugation-bellows;

2x1W - straight bellows

further bellows versions on request

Bestellbeispiel:
ordering example:

EWP 100 / 2x1W

EWP 450 / 4W - Øe = 48 H7 / 8 M8 / Øc = 60 / L = 57